

WELCOME HOME
to Champlain Shores

BEAUSOLEIL



3 Beds



3 Bath



±2,168 sq. ft.



2 Garage

Champlain Shores is a community built for those ready to embrace life by the water. Just 45 minutes north of Barrie in the small town of Penetanguishene, it's a place where you can find both vibrant energy and quiet relaxation. With scenic trails, Georgian Bay at your doorstep, and dockage for easy access to explore by water, Champlain Shores offers the best of outdoor living alongside all the essentials—local shops, healthcare, schools, and year-round adventure from skiing to snowmobiling.

Whether you're taking in endless sunsets, setting off on scenic trails, or enjoying waterfront views, this is where your next chapter begins.



Side Elevation



Side Elevation



Front Elevation



Back Elevation



Ground Floor

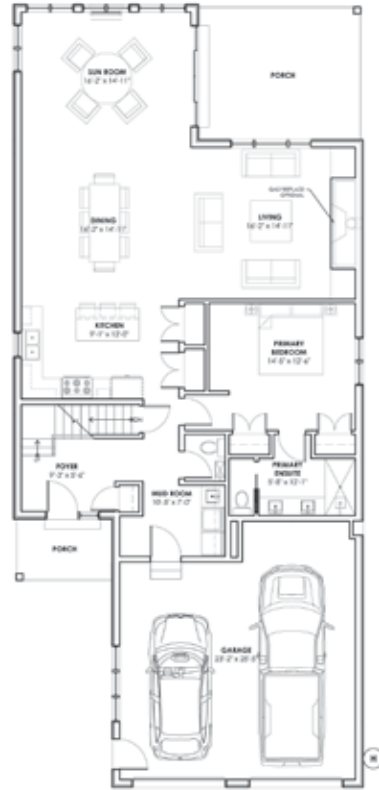

TOTAL AREA: ± 1,574 sq.ft
GARAGE: ± 594 sq.ft
PORCH: ± 263 sq.ft

Second Floor (Optional bonus room)

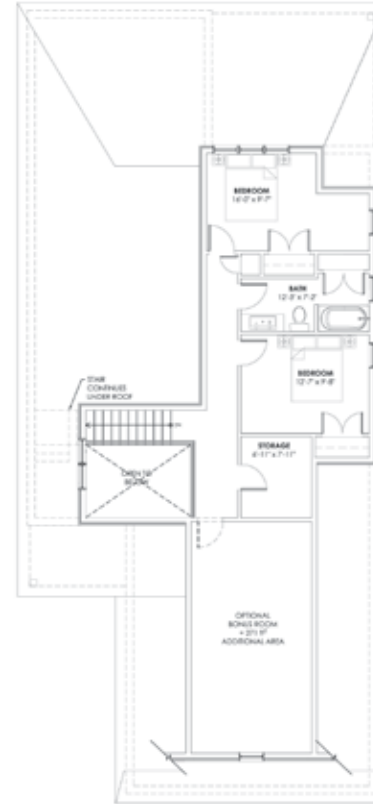

TOTAL AREA: ± 594 sq.ft
BONUS ROOM: ± 271 sq.ft

Crawl Space Standard (Basement optional where allowed)

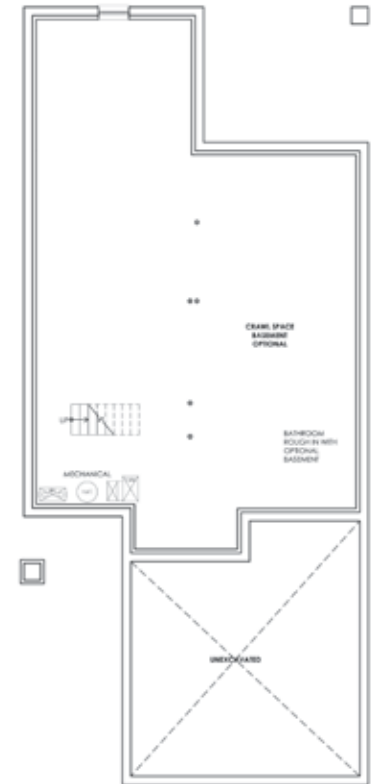

TOTAL AREA: ± 1,574 sq.ft

NOTE: "PLANS, DIMENSIONS AND SPECIFICATIONS ARE APPROXIMATE AND SUBJECT TO CHANGE WITHOUT NOTICE. FURNITURE IS FOR ILLUSTRATIVE PURPOSES ONLY AND IS NOT INCLUDED. ILLUSTRATIONS AND PHOTOGRAPHS MAY BE UPGRADED FEATURES AND/OR ARTIST'S CONCEPTION. E&O.E."

CHAMPLAIN *Shores*

DISCOVER MORE ONLINE

